

Absorption of vibration

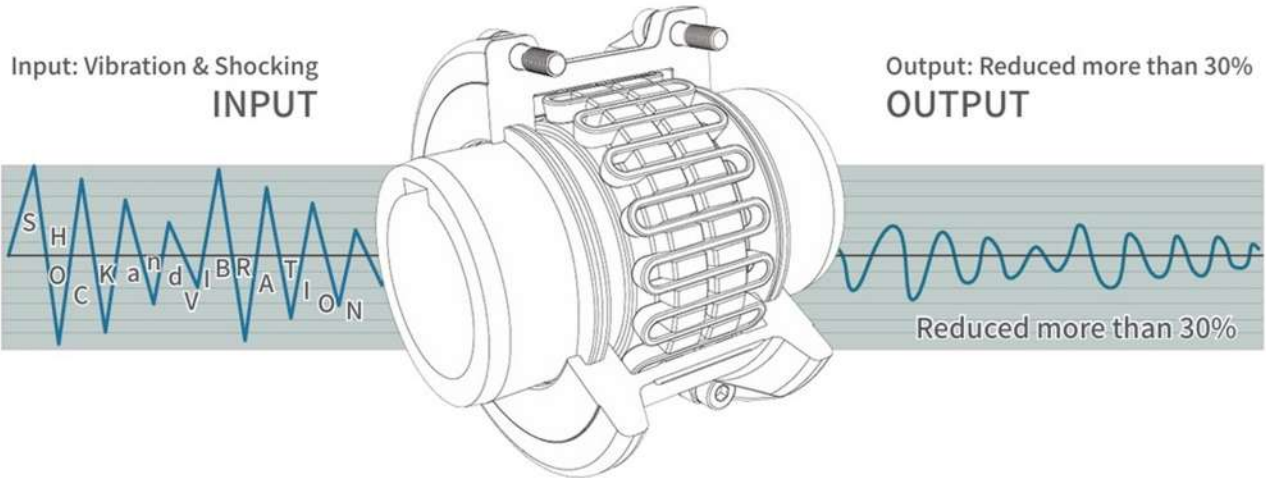

Vibration/ Shock load absorption

* PTC grid coupling demonstrate the excellent performance as shown below.

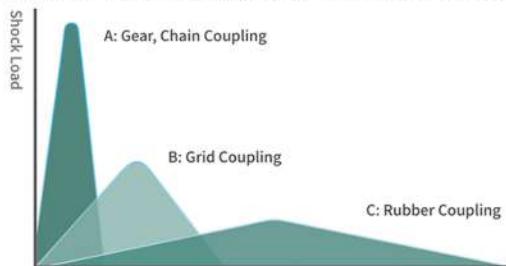

* PTC grid coupling demonstrate the excellent performance as shown below.

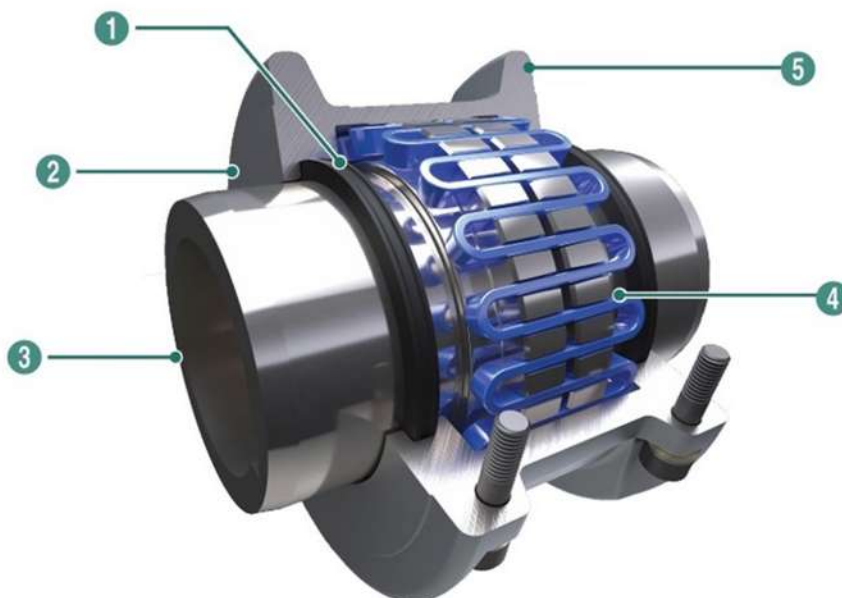
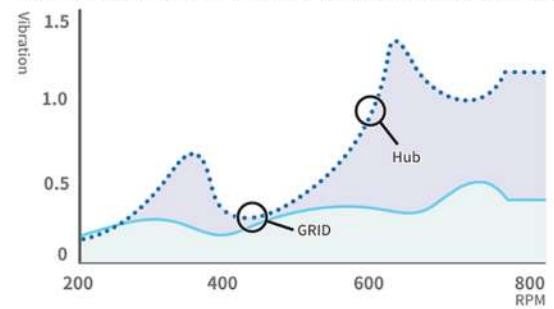

Parts

- 1 Oil seal : NBR
- 2 Cover : ALDC12
- 3 Hub : S45C
- 4 Grid : SWRH62B
- 5 Gasket : UG

Grid Coupling

Dimensions

Type T10 (Horizontal Split Aluminum Cover)
Or TH

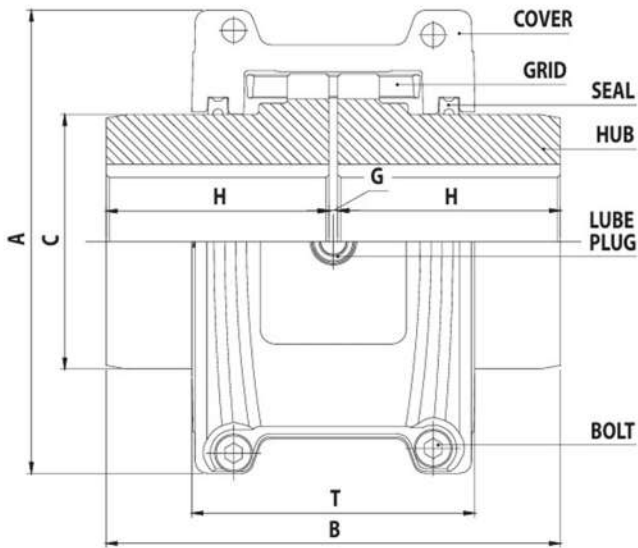

SIZE	MAX SPEED (RPM)	BASIC TORQUE (Nm)	BORE DIA(mm)		DIMENSIONS(mm)					G			CPLG WT(kg)	LUBE WT(kg)
			MAX	MIN	A	B	C	H	T	MIN	NORMAL	MAX		
1020	4,500	52	30	12.7	97	98.0	39.7	47.5	66.58	1.5	3.0	4.5	1.7	0.03
1030	4,500	149	36	12.7	106.1	98.0	49.2	47.5	68.3	1.5	3.0	4.5	2.3	0.03
1040	4,500	249	44	12.7	114.6	104.6	57.1	50.8	69.6	1.5	3.0	4.5	3.1	0.05
1050	4,500	435	50	12.7	135.6	123.6	66.7	60.3	81.1	1.5	3.0	4.5	5.1	0.05
1060	4,350	684	57	19.1	148.1	130.0	76.2	63.5	93.78	1.5	3.0	4.5	7.0	0.09
1070	4,125	994	65	19.1	158.6	155.4	87.3	76.2	96.74	1.5	3.0	4.5	9.9	0.11
1080	3,600	2,051	79	27.0	190.3	180.8	104.8	88.9	115.47	1.5	3.0	6.0	17.0	0.17
1090	3,600	3,728	95	27.0	210.5	199.8	123.7	98.4	122.56	1.5	3.0	6.0	24.9	0.25
1100	2,400	6,276	107	41.3	251	245.7	142.0	120.6	155.05	1.5	4.5	9.5	40.9	0.43
1110	2,250	9,321	117	41.3	269.5	258.5	160.3	127.0	161.03	1.5	4.5	9.5	52.4	0.51
1120	2,025	13,671	136	60.3	308.7	304.4	179.4	149.2	191.39	1.5	6.0	12.5	80.5	0.73
1130	1,800	19,885	165	66.7	346.8	329.8	217.5	161.9	195.09	1.5	6.0	12.5	118.5	0.91
1140	1,650	28,585	184	66.7	384.8	371.6	254.0	182.8	200.89	1.5	6.0	12.5	179	1.13
1150	1,500	39,771	203	108.0	453.54	371.8	269.0	182.9	276.07	1.5	6.0	12.5	234.0	1.95
1160	1,350	55,927	228	120.7	503	402.2	305.0	198.1	280	1.5	6.0	12.5	317.0	2.81
1170	1,225	74,570	279	133.4	568.4	437.8	356.0	215.9	309.4	1.5	6.0	12.5	448.0	3.49
1180	1,100	103,381	311	152.4	631.6	483.6	394.0	238.8	322	1.5	6.0	12.5	619.0	3.76
1190	1,050	136,712	339	152.4	677	524.2	437.0	259.0	331.56	1.5	6.0	12.5	776.0	4.40
1200	900	186,425	361	177.8	760	564.8	497.8	279.4	359.48	1.5	6.0	12.5	1,057.0	5.62

Grid Coupling

WCC

Dimensions

Type T20 (Vertical Steel Cover)
Or TV

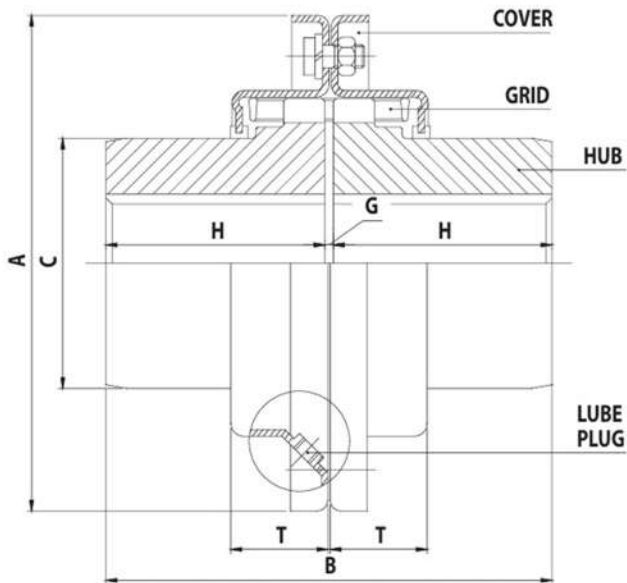

SIZE	MAX SPEED (RPM)	BASIC TORQUE (Nm)	BORE DIA (mm)		DIMENSIONS(mm)					G			CPLG WT (kg)	LUBE WT (kg)
			MAX	MIN	A	B	C	H	T	MIN	NORMAL	MAX		
1020	6,000	52	30	12.7	111.1	98.0	39.7	47.5	24.4	1.5	3	4.5	1.7	0.03
1030	6,000	149	36	12.7	120.65	98.0	49.2	47.5	25.2	1.5	3	4.5	2.3	0.03
1040	6,000	249	44	12.7	128.5	104.6	57.1	50.8	26	1.5	3	4.5	3.1	0.05
1050	6,000	435	50	12.7	147.6	123.6	66.7	60.3	31.4	1.5	3	4.5	4.9	0.05
1060	6,000	684	57	19.1	162	130.0	76.2	63.5	32.2	1.5	3	4.5	6.6	0.09
1070	5,500	994	65	19.1	173	155.4	87.5	76.2	33.8	1.5	3	4.5	9.4	0.11
1080	4,750	2,051	79	27.0	200	180.8	104.8	88.9	44.1	1.5	3	4.5	16	0.17
1090	4,000	3,728	95	27.0	231.77	199.8	123.8	98.4	47.3	1.5	3	6.0	23.7	0.25
1100	3,250	6,276	107	41.3	266.7	245.7	142.0	120.6	60.2	1.5	4.5	9.5	40.1	0.43
1110	3,000	9,321	117	41.3	285.75	258.5	160.3	127.0	63.3	1.5	4.5	9.5	51.7	0.51
1120	2,700	13,671	136	60.3	319	304.4	179.4	149.2	73.75	1.5	6	12.5	78.3	0.73
1130	2,400	19,885	165	66.7	377.8	371.6	217.5	161.9	75.4	1.5	6	12.5	114.8	0.91
1140	2,200	28,585	184	66.7	416	372	254.0	183	78.5	1.5	6	12.5	174.5	1.13
1150	2,000	39,771	203	108.0	479	372	269	183	106	1.5	6	12.5	238.0	1.95
1160	1,750	55,927	228	120.7	532	402.2	305	198.1	114	1.5	6	12.5	322.8	2.81
1170	1,600	74,570	279	133.4	590	437.8	356	215.9	119	1.5	6	12.5	448.8	3.49
1180	1,400	103,381	311	152.4	630	483.6	394	238.8	129	1.5	6	12.5	591	3.76
1190	1,300	136,712	339	152.4	685	524.2	437	259.1	144	1.5	6	12.5	761	4.40
1200	1,100	186,425	361	177.8	737	564.8	497.8	279.4	145	1.5	6	12.5	1021	5.62

Installation

The operation and life of PTC grid coupling may be highly influenced by how it is installed and used. To successfully operate and use it without trouble, it must be installed and used in accordance with the provided manual. Only standard tools are required for installation: a wrench, a straight edge ruler, and a feeler or dial gauge.

Details for installation

- 1** Clean all parts with cleansing oil, assemble the Oil seal and insert hub into the shaft.
- 2** Insert clearance gauges to adjust the clearances and angular errors. At four points spaced 90 degrees around the coupling circumference.
- 3** Adjust the parallel errors every 90 degrees in circumference using a straight edge ruler, and adjust errors for the shaft centers more accurately using a dial gauge.
- 4** Fill the groove on the teeth of the hub with grease, ensuring that the ends of the grid sections face the same direction, and then insert them tapping with a rubber hammer.
- 5** Apply enough Grease to the grid and place the oil seal where it fits well into the groove of the cover. Insert gasket and assemble the cover to ensure that match marks inside the latter are on the same side.

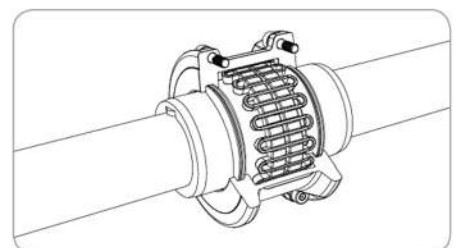
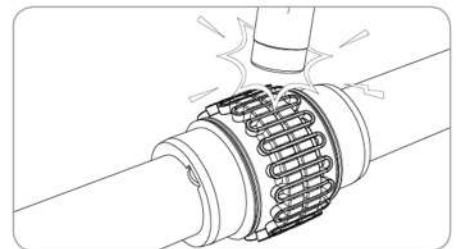
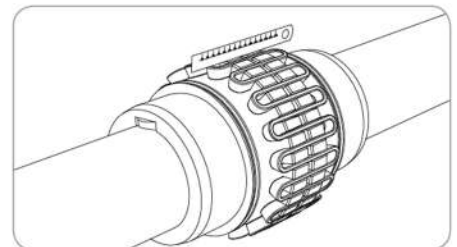
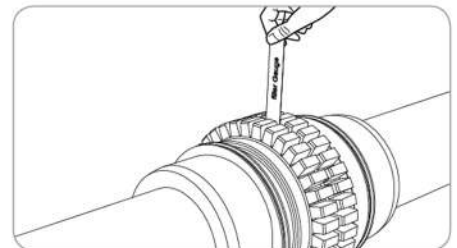
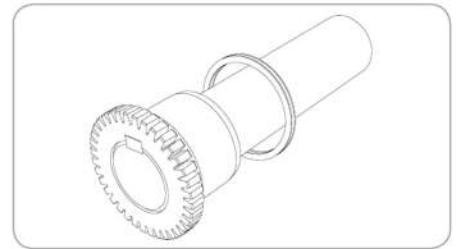

I Disassembly

When disassembling the coupling, lift ends of the Grid ring using a screwdriver as shown in the figure, alternately both sides from the end of the Grid section.

I Periodic maintenance

The maintenance should be done once a year according to the following procedure.

- 1** Check the alignment of the shaft. If the alignment is out of limits, re-install it to align again.

- 2** Ensure that all Fasteners are tightened for the torque.

- 3** Check the conditions of Oil-Seal and Gasket. If even a small amount of Grease leaks, the parts must be replaced regardless of periodic maintenance.

- 4** After removing the cover, if you can find any parts that need to be replaced by visual inspection, replace them, apply Grease again, and assemble it with new Gasket and Oil Seal.

